

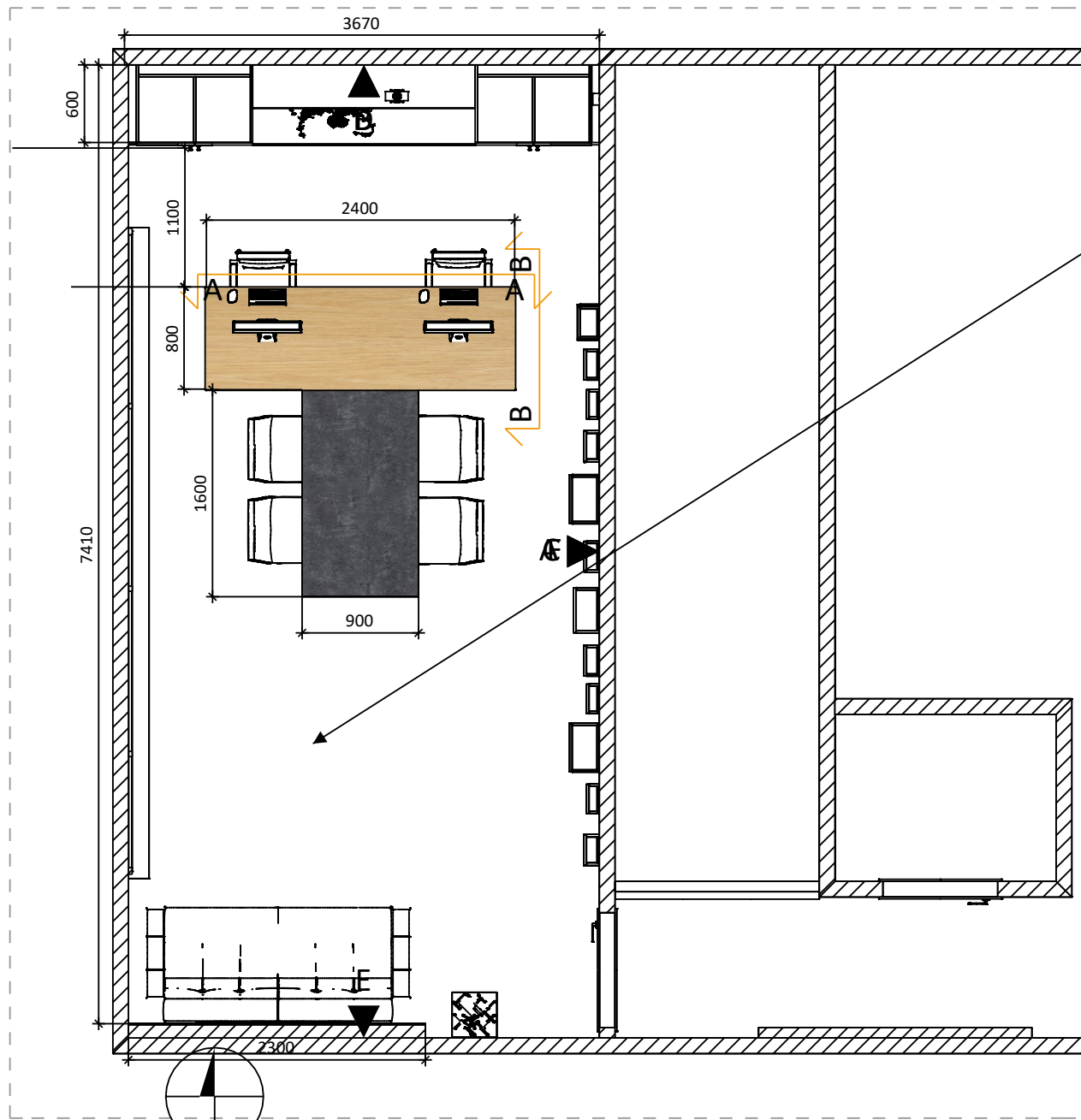

Projekt biura

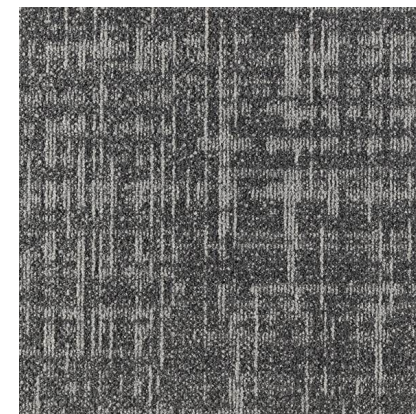



Płytki dywanowa 50x50
Modulyss CORE 901 A



	NR RYS.	NAZWA PROJEKTU Biuro Lubelska	SKALA 1:50	INWESTOR	PROJEKTANT Marzena Repecka	PODPIS PROJEKTANTA
---	----------------	---	----------------------	-----------------	--------------------------------------	---------------------------

Kład A

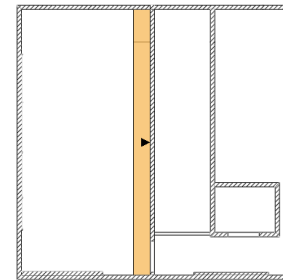
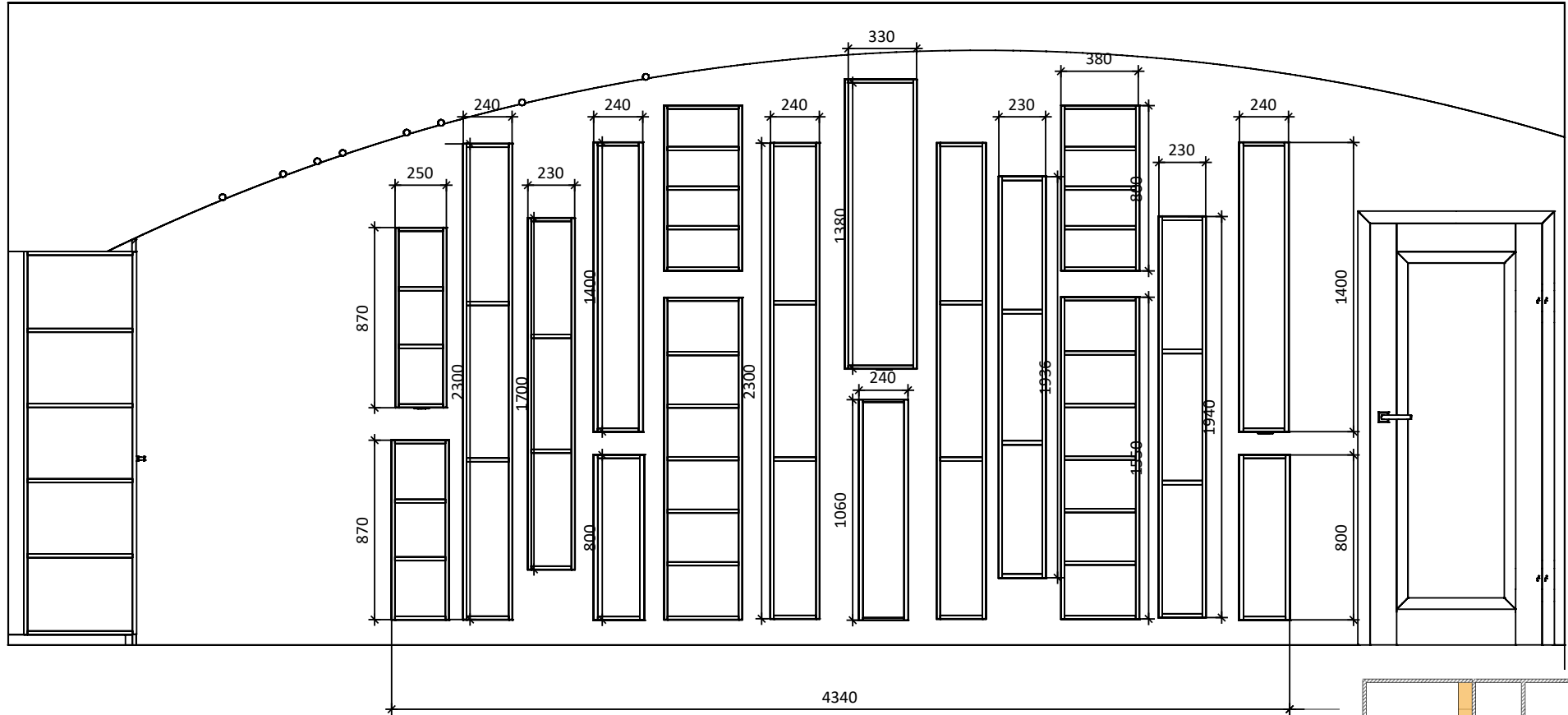

	NR RYS.	NAZWA PROJEKTU Biuro Lubelska	SKALA 1:30	INWESTOR	PROJEKTANT Marzena Repecka	PODPIS PROJEKTANTA
--	---------	----------------------------------	---------------	----------	-------------------------------	--------------------

Kład A materiał

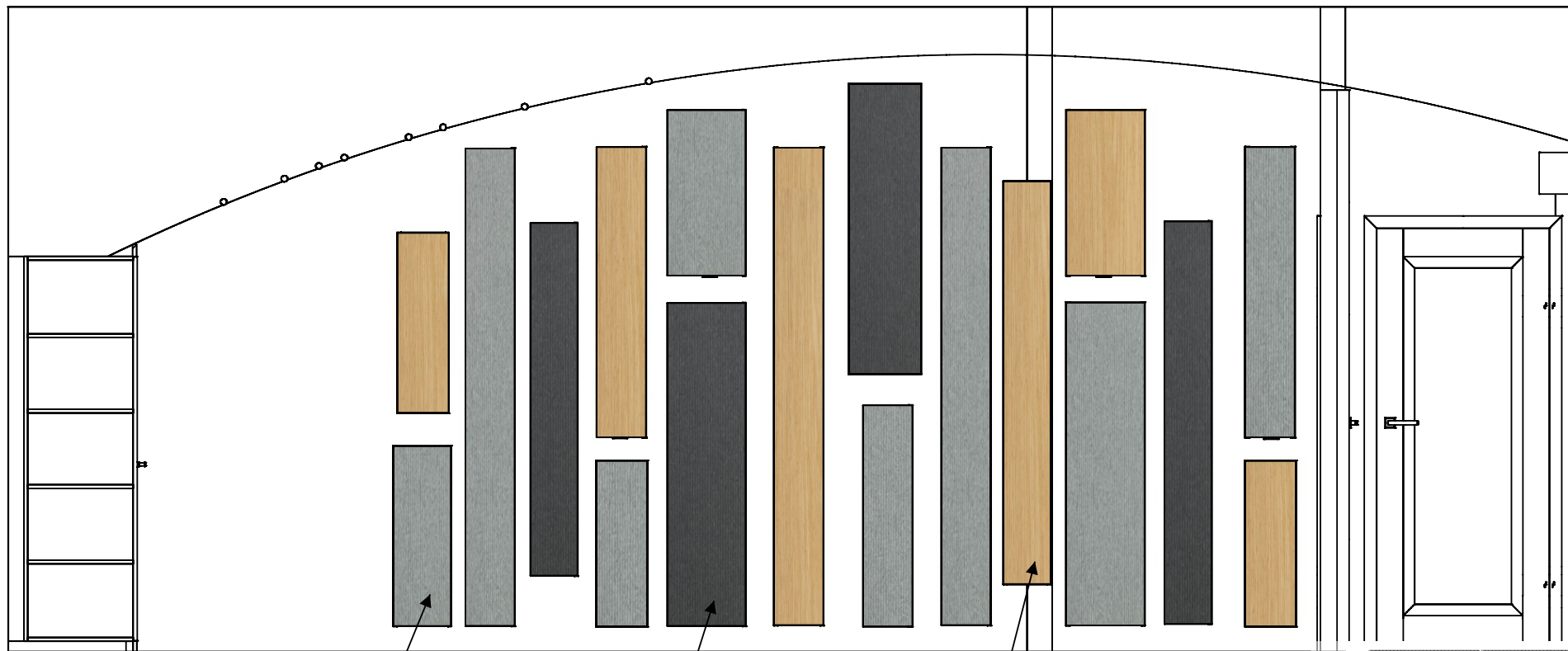

Forner forrest
KL 2331 standard



Forner forrest
KL 2333 standard

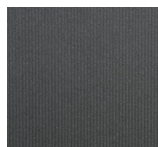

Fornir dąb naturalny

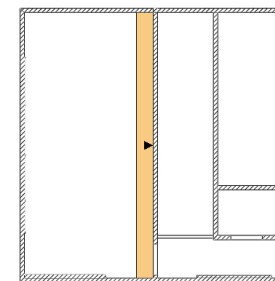
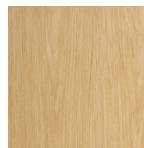

Kład A oświetlenie pod szafkami

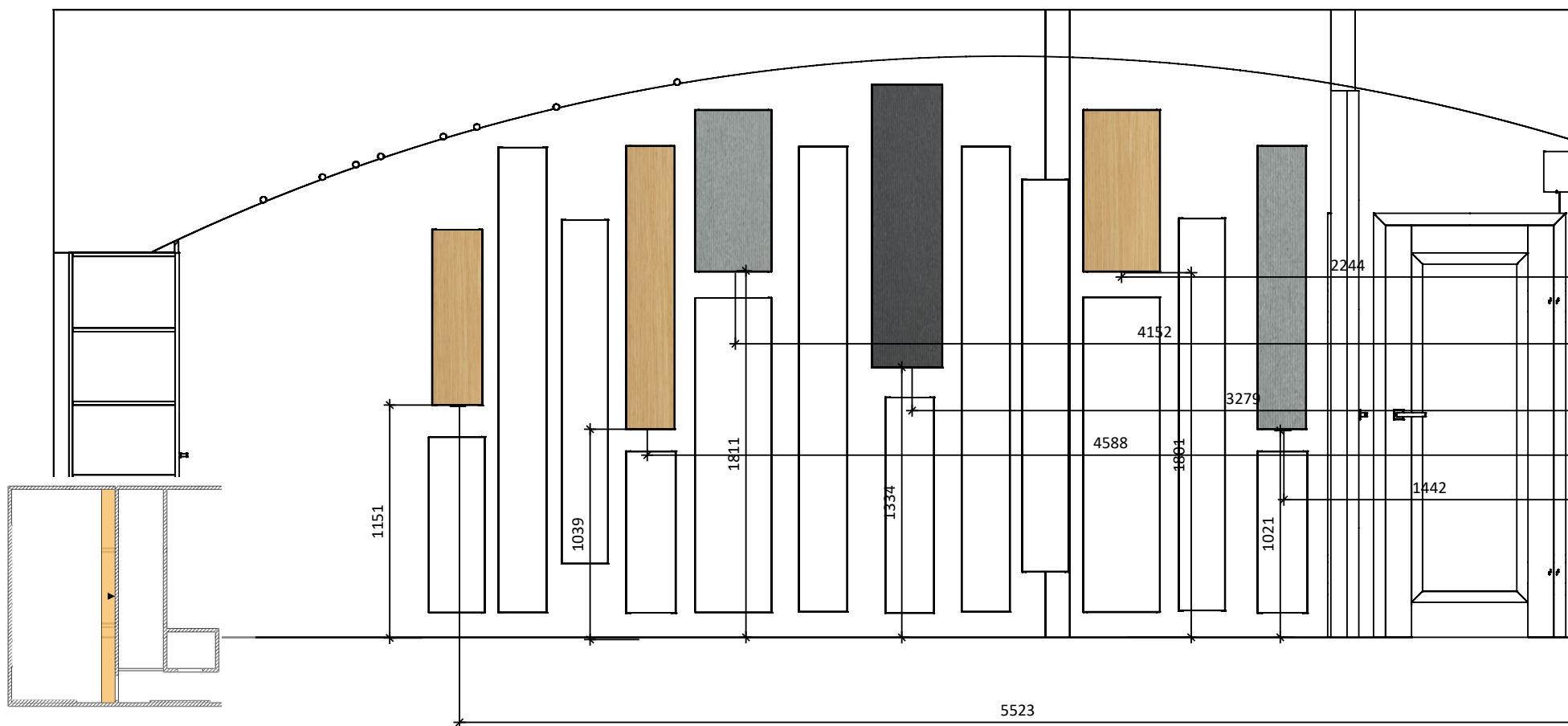

NR RYS.

NAZWA PROJEKTU
Biuro Lubelska

SKALA
1:30

INWESTOR

PROJEKTANT
Marzena Repecka

PODPIS PROJEKTANTA

Kład B materiały

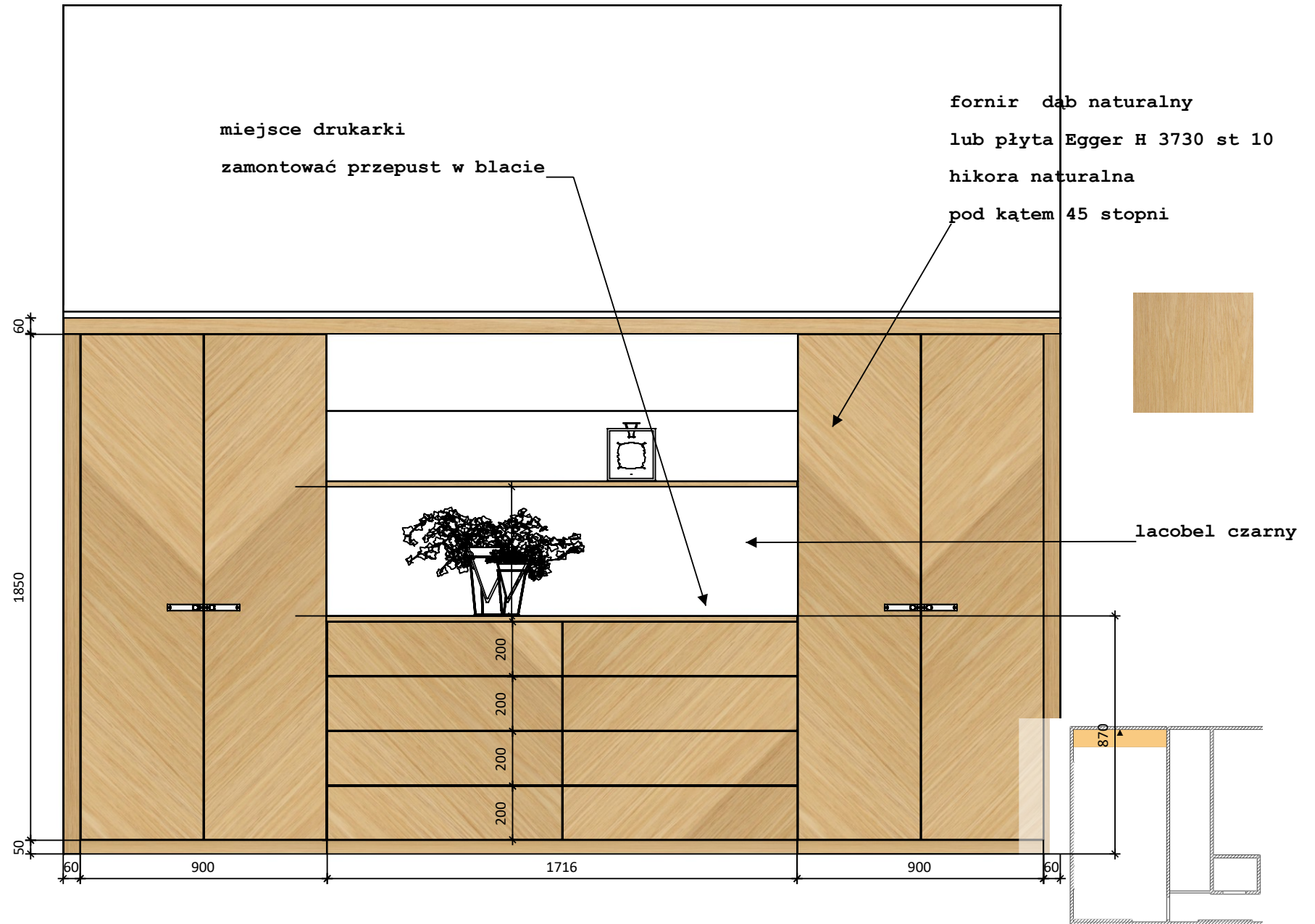

Kład C

wieszak stojący

Latva czarny

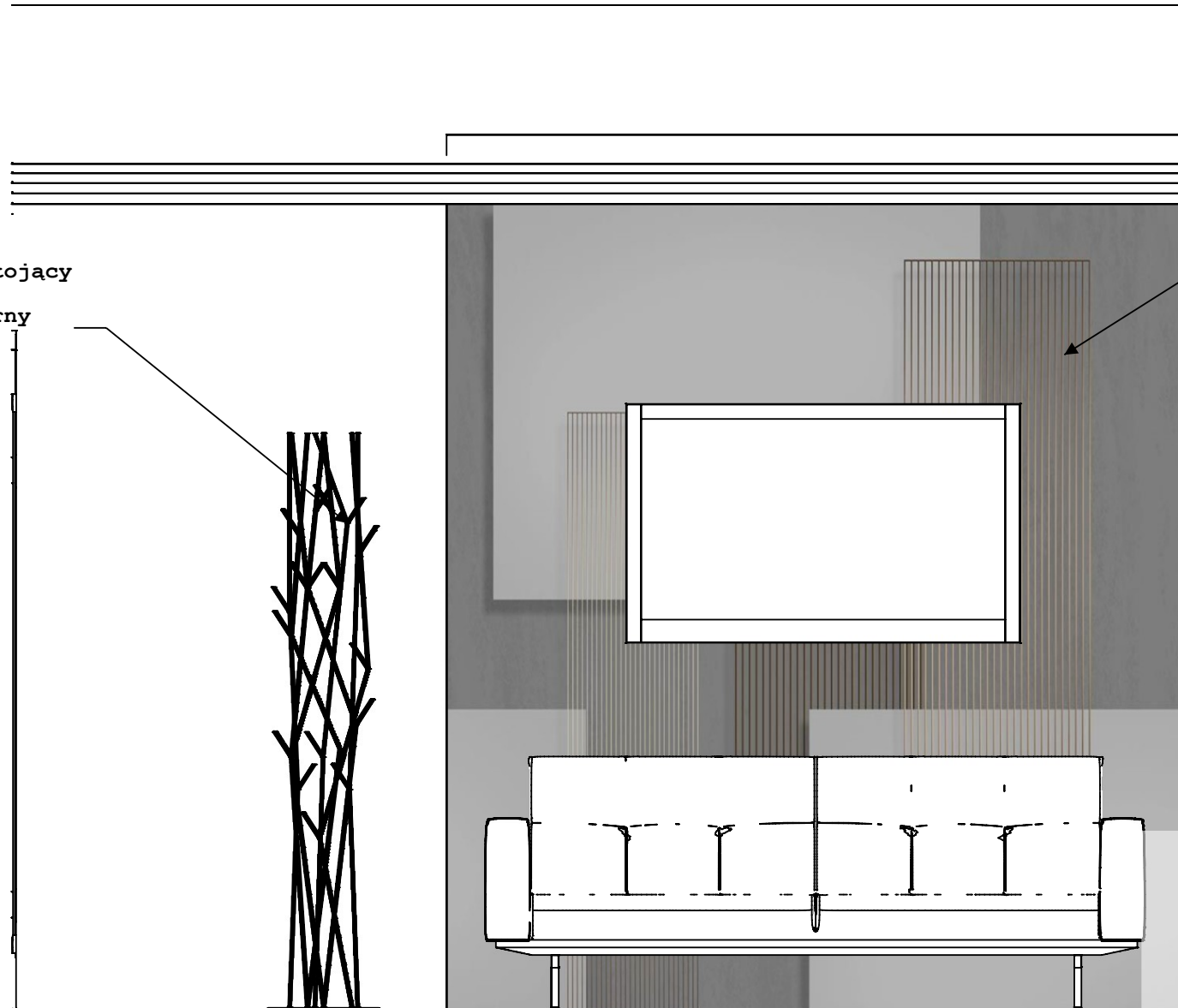

Tapeta London ART

19036004

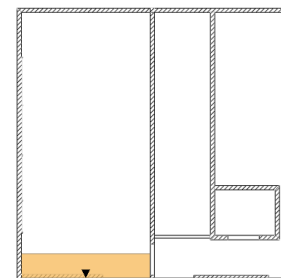
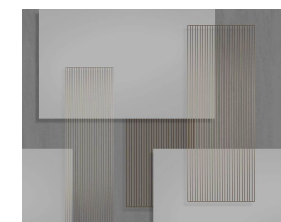

NR RYS.

NAZWA PROJEKTU
Biuro Lubelska

SKALA
1:20

INWESTOR

PROJEKTANT
Marzena Repecka

PODPIS PROJEKTANTA

Wymiary biurka

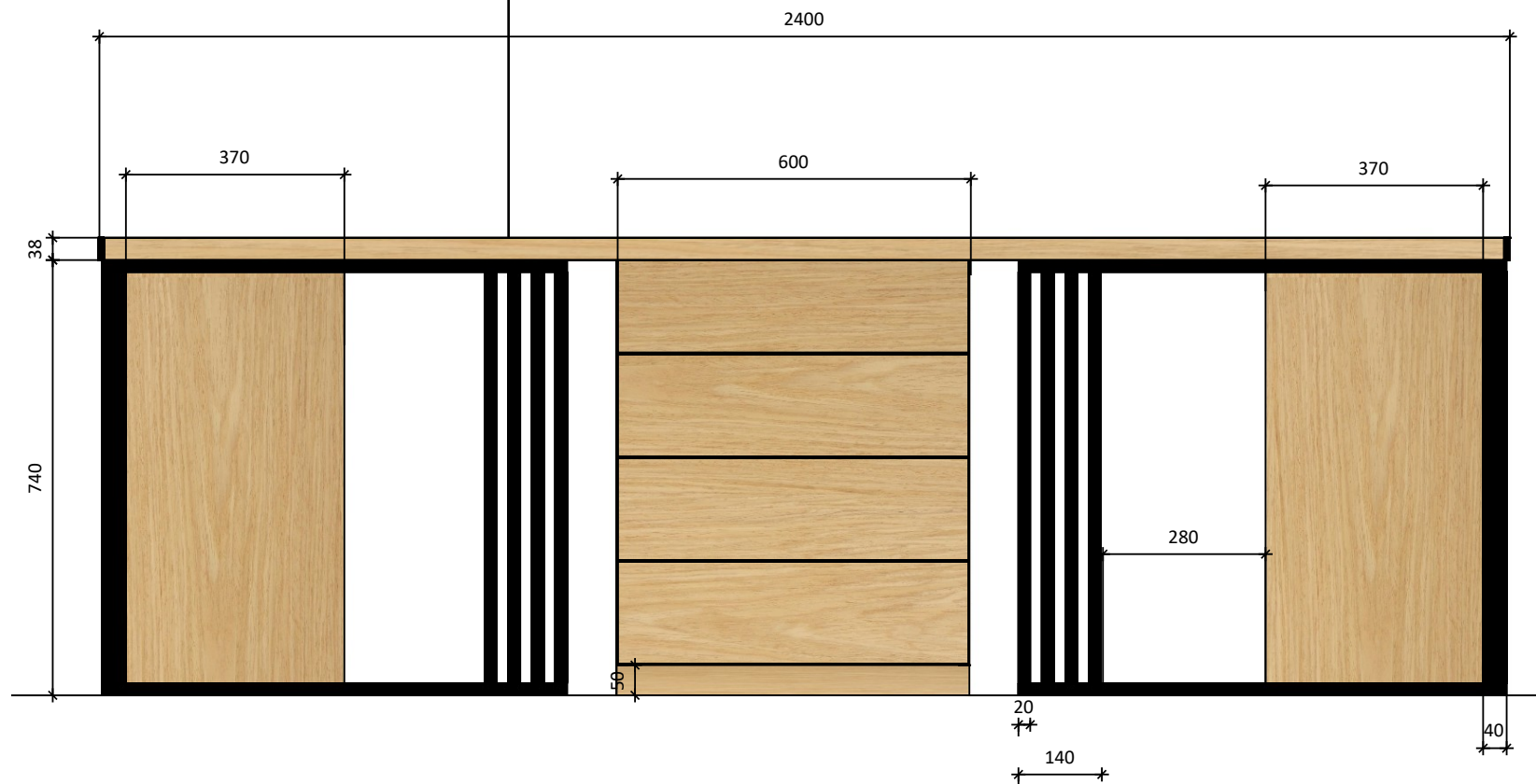

Bok biurka

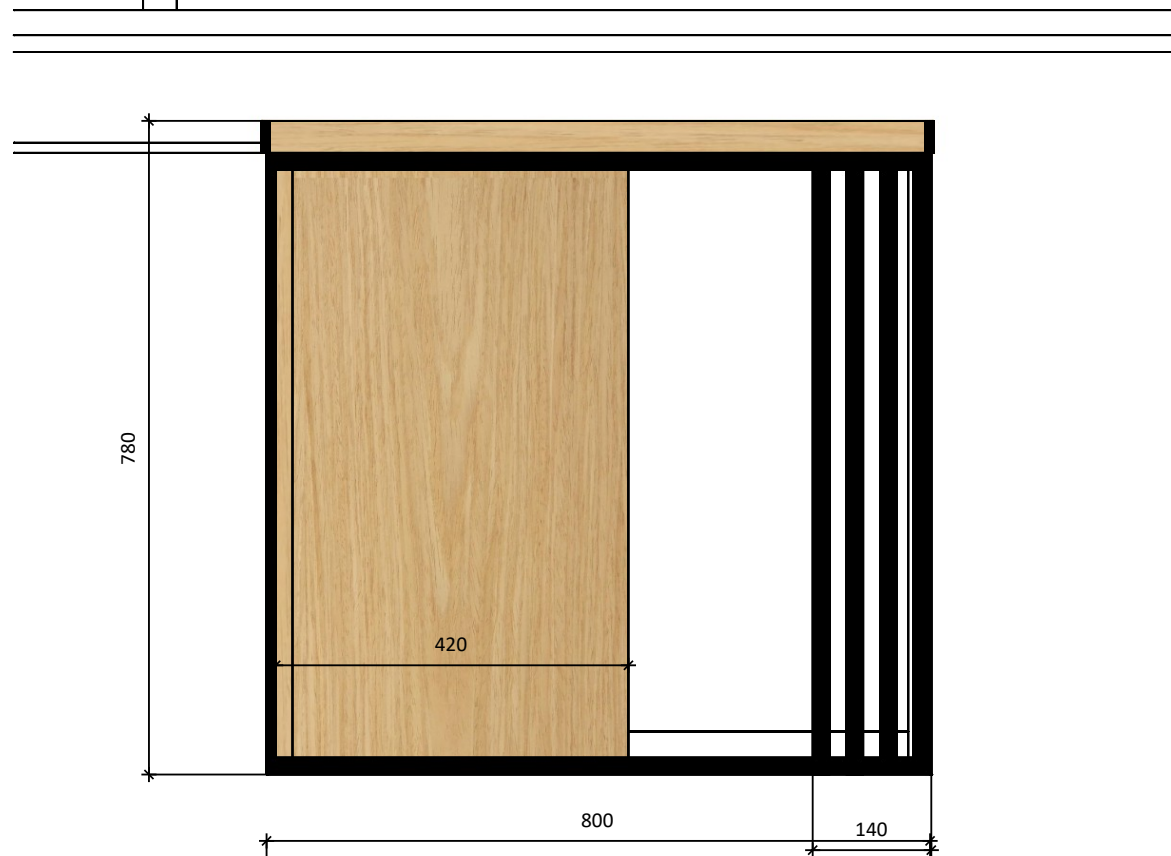



wymiary biurka

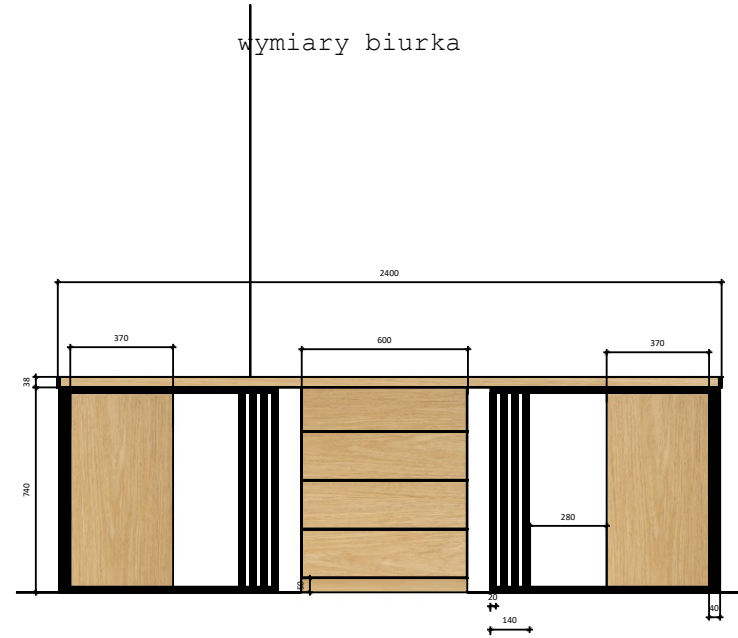

wykonać stelaż metalowy
malowany proszkowo na kolor czarny